



KITCHEN SINK 6VEL™



GUITAR AMPLIFIER

USER'S GUIDE

Your 3RD POWER Amplifier is a professional musical instrument amplifier. The information contained herein is current at the time of publication. However, specifications are subject to change without prior notice.

PRECAUTIONS & WARNINGS

- **READ THESE INSTRUCTIONS.**
- **KEEP THESE INSTRUCTIONS.**
- **HEED ALL WARNINGS.**
- **FOLLOW ALL INSTRUCTIONS.**
- **YOUR AMPLIFIER IS LOUD!
EXPOSURE TO HIGH SOUND VOLUMES MAY CAUSE PERMANENT HEARING DAMAGE !
Practice "safe listening."**
- **No user serviceable parts inside. Refer service to qualified personnel. Always unplug AC power before removing chassis.**
- **IF YOU INTEND ON OPERATING THIS EQUIPMENT OUTSIDE OF THE USA: Always insure that unit is wired for proper voltage. Make certain all connections and grounding conforms with local standards. Make certain that you have obtained authorization to operate prior to connecting to power supply.**
- **WARNING: Vacuum tube amplifiers generate heat. To insure proper ventilation always make certain there is at least four inches (100mm) of space behind the rear of the amplifier cabinet.**
- **Keep away from curtains or any flammable objects.**
- **WARNING: Do not block any ventilation openings on the rear or top of the amplifier. Do not impede ventilation by placing objects on top of the amplifier which extend past the rear edge of its cabinet.**
- **WARNING: Do not expose the amplifier to rain, moisture, dripping or splashing water. Do not place objects filled with liquids on or nearby the amplifier.**
- **WARNING: Always make certain proper load is connected before operating the amplifier. Failure to do so could pose a shock hazard and may result in damage to the amplifier.**
- **Do not expose amplifier to direct sunlight or extremely high temperatures.**
- **Always insure that amplifier is properly grounded. Always unplug AC power cord before changing fuse or any tubes. When replacing fuse, use only same type and rating.**
- **Avoid direct contact with heated tubes. Keep amplifier away from children.**
- **Be sure to connect to an AC power supply that meets the power supply specifications listed on the rear of the unit. Remove the power plug from the AC mains socket if the unit is to be stored for an extended period of time. If there is any danger of lightning occurring nearby, remove the power plug from the wall socket in advance.**
- **To avoid damaging your speakers and other music equipment, turn off the power of all related equipment before making the connections.**
- **Do not use excessive force in handling control buttons, switches and controls. Do not use solvents such as benzene or paint thinner to clean the unit. Wipe off the exterior with soft cloth.**
- **WARNING: Cancer and Reproductive Harm <http://www.p65warnings.ca.gov>**

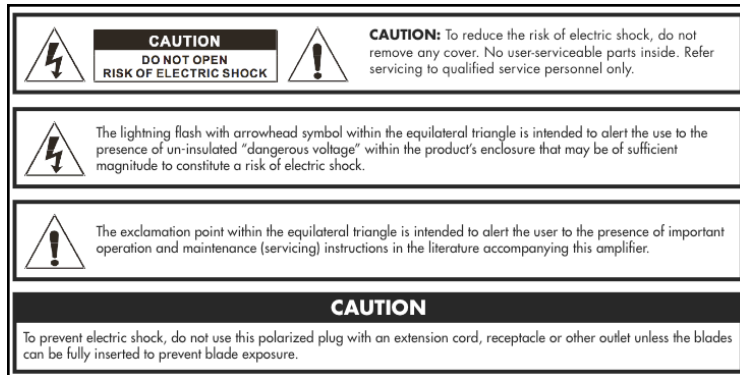

MOVING FORWARD... IN 3D

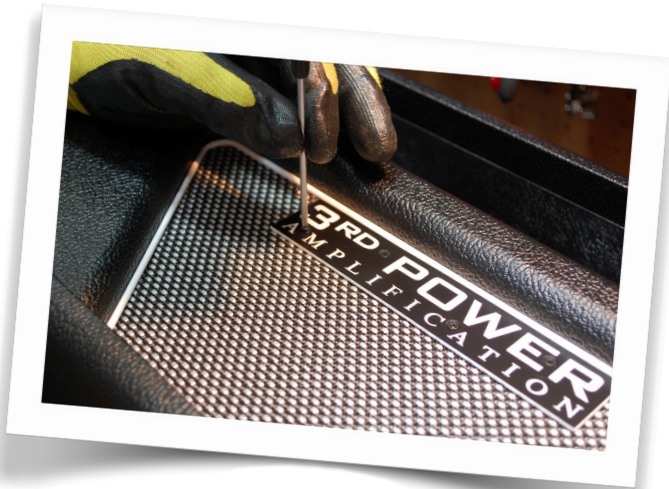

Thank you for choosing the KITCHEN SINK 6VEL by 3RD POWER as an integral part of your musical journey.

Music is a powerful blend of tone, attitude, and technique. When the right combination comes together, something extraordinary happens—it becomes an experience felt by everyone.

For over 30 years, I've had the incredible privilege of performing on stages and in studios, pursuing the sounds and responses

that make music truly come alive. As the principal visionary behind 3RD POWER, every product we design reflects that lifelong pursuit—shaped by my experience, energy, and passion for creating meaningful musical tools.

Each amplifier we build is designed to help you tell your story with greater depth, dimension, and connection.

Moving Forward... in 3D

Rock on!
- Dylana Nova Scott



Special Features of the Kitchen Sink 6VEL™:

- Two fully footswitchable channels (Clean and Dirty)
- Clean Channel Voicings: Blackface, Brownface, AC, and Top Boost
- BIG Control: Exclusive preamp blend control on Channel 1
- Dirty Channel Voicings: Multi-voiced Plexi architecture (JTM and JMP)
- Footswitchable preamp gain boost
- Compatible with multiple power tube platforms:
 - 6V6 (20W)
 - EL34 (40W)
 - 6L6
 - 5881
- Rear-panel bias test points and adjustment control
- Switchable power supply rectification:
 - Solid State
 - Tube Rectifier (5AR4/GZ34 or 5U4GB)
- Tube-driven effects loop (footswitchable)
- Tube-driven spring reverb (channel assignable)
- Hybrid-MASTER™ volume control
- Venue Mode™ attenuator system
- Footswitchable Hybrid-MASTER™ Bypass (Boost Function): Create custom volume level presets for seamless rhythm and lead scene changes, allowing instant live recall via footswitch.
- Included 4-button professional footswitch
- Optional Breakout Box: Available separately for seamless integration of the amplifier's footswitchable functions with third-party remote switching systems.
- Limited Lifetime Warranty

Dimensions & Weights:

Subject to change anytime. Please measure your amp carefully if a custom case is being made. These measurements do not include handle and rubber feet.

Kitchen Sink Amp Head: Dimensions (WxHxD): 24 x 10.5 x 9.33 in.

Weight: 29.5 lb.

112 Combo: Dimensions (WxHxD): 25 x 20.75 x 11 in.

Weight: 57 lb.

Front Panel: Master Section



Preparing to Operate your Kitchen Sink 6VEL™

Before operating your amplifier, ensure that all connections are properly made, including the power cable, speaker connection, instrument cable, and instrument connection. Confirm that all tubes are correctly installed before powering on the amplifier.

Power Switch (1)

The POWER switch, when placed in the DOWN position, provides AC wall power to the amplifier.

Standby Switch (2)

The STANDBY switch, when placed in the CENTER position, puts the amplifier in Standby Mode, allowing the tubes to properly warm up. When the switch is placed in the UP position, the amplifier is fully operational in diode rectified mode. When placed in the DOWN position, the amplifier is fully operational in tube rectified mode. See pages 18 - 20 for additional information.

Hybrid-MASTER™ Control (3)

The MAIN control is always active and sets the absolute volume ceiling. The foot-switchable HM bypass control will be covered later in the manual. Hybrid-MASTER™ is a patented technology developed by 3RD POWER.

Push Control (4)

The global PUSH control affects both channels and allows you to adjust the low-frequency character of your sound. Lower settings provide a tighter, more focused response, while higher settings deliver increased punch, thump, and low-frequency push.

Presence Control (5)

The global PRESENCE control affects both channels and allows you to adjust the high-frequency character of your sound. Lower settings produce darker, smoother tones, while higher settings add brilliance, clarity, and crisp high-end response.

Front Panel: Reverb Level and Assignment

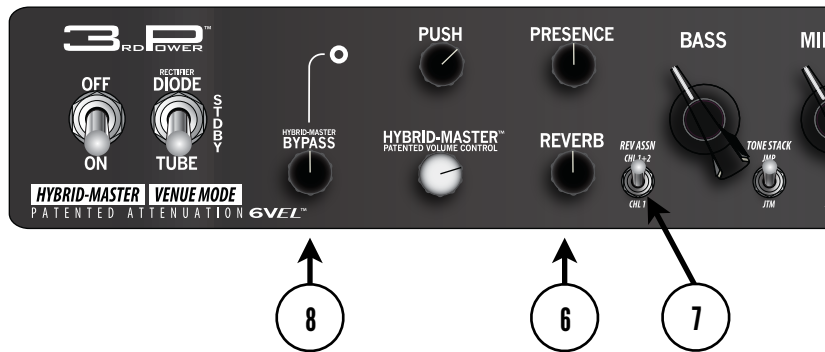

Reverb Control (6)

Adjusts the amount of ambience added to your sound. The reverb circuit uses pure Class A tube drive and recovery for authentic vintage-style spring reverb.

Reverb Assign Switch (7)

Assigns tube-driven spring reverb to both channels (up) or the clean channel only (down).

HM Bypass Control (8)

The HM Bypass control is permanently assigned to the FS Bus (far-right footswitch button). To disable the boost function, simply turn the Bypass control fully counterclockwise to zero.

For proper setup, begin with the Bypass control at zero. Dial in your desired rhythm volume using the Hybrid-MASTER™ control (a good starting point is approximately 11 o'clock). Once your rhythm volume is set, engage the HM Bypass function on the footswitch and gradually increase the Bypass control until your ideal lead boost level is achieved.

This setup allows instant switching between your rhythm preset and boosted lead volume.

Front Panel: Input and Channel Selection

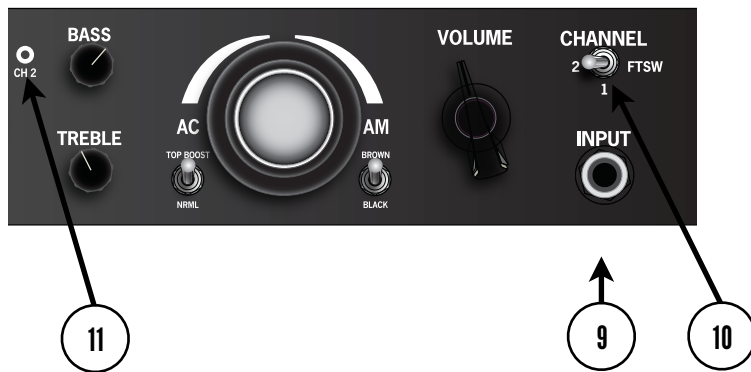

Input Jack (9)

The INPUT jack is used for connecting instrument-level signals to the amplifier.

Channel Selector Switch (10)

The channel selector switch operates as follows:

- Middle Position: Selects the Clean channel
- Left Position: Selects the Dirty channel
- Right Position: Enables Footswitch Mode for remote channel switching

Channel Indicator Lamp (11)

The Channel indicator lamp glows red when the dirty channel is active.

Front Panel: Clean Channel

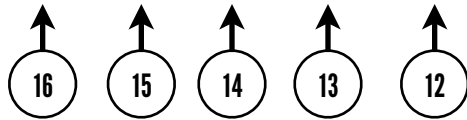

Volume Control (12)

The VOLUME control adjusts the signal level while also shaping the temperament and overall character of your instrument's sound, ranging from clean tones to edge-of-breakup response.

Brown/Blackface Switch (13)

The Brownface/Blackface toggle switch allows you to select between two distinct preamp operating modes, offering a wide range of tonal character. Brown Position: Delivers a wide, warm voice with enhanced midrange emphasis. Clean tones are earthy and rich, while pushed settings produce focused, expressive overdrive. Black Position: Provides a tighter, spankier response with increased clean headroom. Clean tones are fast, punchy, and feature classic American-style chime, while higher settings produce big, edgy overdrive tones.

The "BIG" Control (14)

The BIG control allows you to select or blend the preamp voicing of your tone, providing a wide spectrum of sonic possibilities. Fully Clockwise: Delivers classic American tonal characteristics. Fully Counterclockwise: Produces the distinct chime and character of mid-'60s British AC-style tones. Intermediate Positions: Allow you to explore and create your own unique blended preamp voices. This control serves as a powerful tonal shaping tool, giving you access to everything from bold American clarity to expressive British chime—and everything in between.

Top Boost Switch (15)

The TOP BOOST switch allows you to adjust the character of the British AC tones only and has no effect on the American voicing.

Tone Controls (16)

The TREBLE control allows you to adjust the character of the higher frequency range. The BASS control allows you to adjust the depth of your lower frequencies.

Front Panel: Dirty Channel

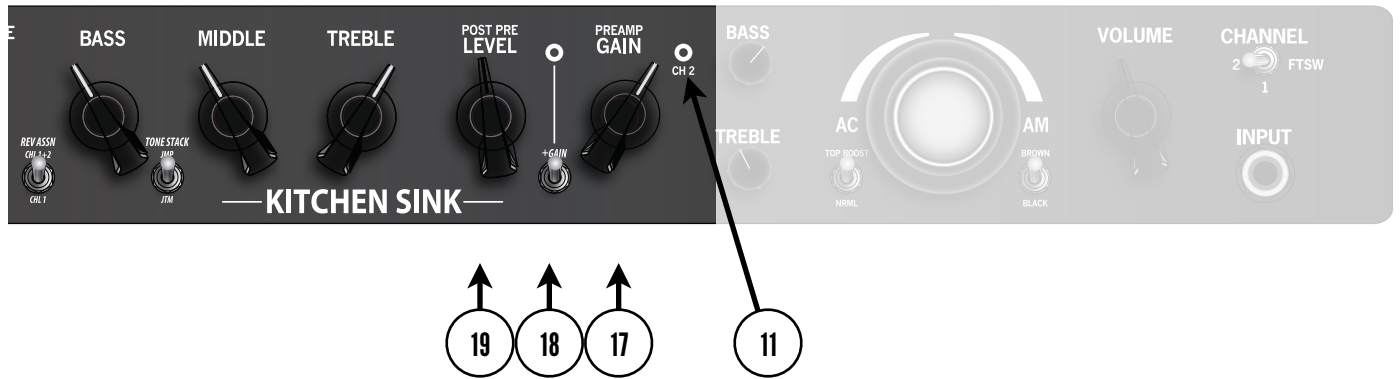

Channel Indicator Light (11)

When selecting channel two, this LED will glow a bright red color indicating that you have selected the Dirty channel for operation. When in this mode, only the Dirty channel controls will be active.

Gain Control (17)

The GAIN control adjusts the signal gain level while shaping the temperament and overall character of your instrument's sound. Lower settings produce cleaner tones, while higher settings progressively increase preamp saturation, distortion, and compression.

+Gain Assign Switch (18)

The +GAIN switch allows you to adjust the response, feel, and overall aggression of the preamp. This feature simultaneously engages additional gain stages while switching clipping diodes in and out of the circuit. These diodes are carefully tuned to provide enhanced compression, tighter response, and increased articulation.

The +GAIN setting is especially well-suited for faster, more aggressive playing styles such as double-picking and sweep-picking, where added precision and control are essential.

This feature may also be assigned to the Footswitch Bus, allowing for convenient remote activation via footswitch.

Post Pre Level Control (19)

The Post Pre Level control adjusts the signal level feeding the FX Loop circuitry while also serving as the final output balance for the Dirty channel.

Lower GAIN Settings: The VOLUME control will typically be set higher (approximately 1 to 2 o'clock)

Higher GAIN Settings: The VOLUME control will generally be set lower (approximately 10 to 11 o'clock).

Use this control to properly balance the overall volume between the Dirty and Clean channels when switching back and forth, ensuring consistent performance levels across both channels.

Front Panel: Dirty Channel - Tone Controls

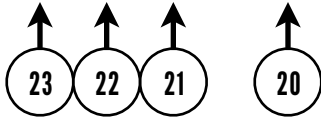
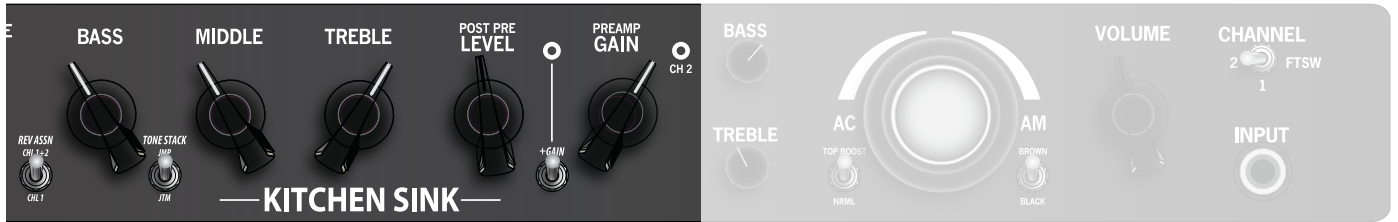

Treble Control (20)

The TREBLE control allows you to adjust the character and response of the higher frequency range, shaping the brightness, clarity, and overall top-end presence of your sound.

Middle Control (21)

The MIDDLE control allows you to adjust the emphasis and character of the midrange frequencies, shaping the body, punch, and overall voice of your sound.

Tone Stack Selector (22)

The TONE STACK SELECTOR switch allows you to adjust the response, feel, and overall voicing of the EQ section. This feature selects between distinct tone stack circuits designed to capture the tonal character and playing response of iconic rock guitar eras.

- JTM: Based on the classic '65 JTM EQ curve. This setting features a scooped midrange, emphasizing lows and highs for a smooth, wide, and highly expressive tonal character.
- JMP: Based on the classic '68 Plexi Super Lead EQ curve. This setting delivers punchy, woody mids with the aggressive growl and authority associated with legendary British rock tones.

Bass Control (23)

The BASS control allows you to adjust the depth, weight, and overall character of the lower frequencies in your sound.

Back Panel: Speaker Outputs

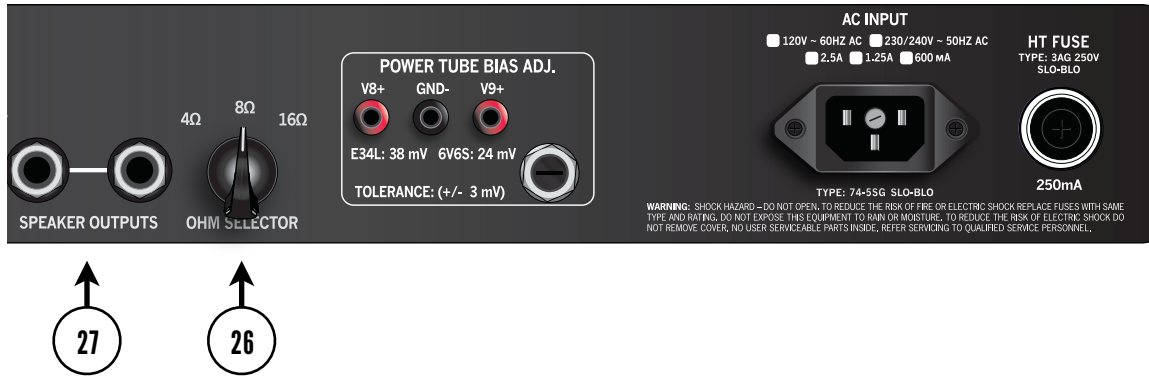

Impedance Selector (26)

The speaker output selector is designed to properly match your amplifier to the correct speaker cabinet impedance:

- 16-OHM Speaker Output: For connection to a single 16-ohm speaker cabinet
- 8-OHM Speaker Output: For connection to a single 8-ohm cabinet or two 16-ohm cabinets
- 4-OHM Speaker Output: For connection to a single 4-ohm cabinet or two 8-ohm cabinets

Always ensure proper impedance matching between the amplifier and speaker cabinet(s) for safe operation and optimal performance.

Speaker Jacks (27)

The SPEAKER OUTPUTS are wired in parallel, allowing multiple speaker cabinets to be connected while maintaining the appropriate total impedance load.

SAFETY NOTES:

- Never operate your amplifier without a properly connected speaker cabinet. Failure to do so may result in severe damage to the power tubes, output transformer, or both.
- Always use the correct speaker output impedance setting to match your connected speaker cabinet(s).
- Always use a high-quality, heavy-gauge speaker cable for speaker connections.
- Never use a shielded instrument cable in place of a speaker cable, as this may cause equipment damage or unsafe operating conditions.

Venue Mode™

Patented Multi-Environment Performance Technology by 3RD POWER

Venue Mode™ is a patented 3RD POWER technology designed to preserve the tonal identity, feel, and dynamic response of your amplifier across a wide range of real-world performance environments.

Unlike conventional attenuators or simple power reduction systems, Venue Mode™ does far more than reduce output volume. It strategically reconfigures critical amplifier performance parameters to help maintain musical integrity, responsiveness, and tonal consistency at lower operating levels.

This allows your Kitchen Sink 6VEL to retain its intended sonic character whether you are recording in the studio, performing on club stages, or operating at full arena-level output.

Practical Benefits:

- Reduces output while preserving exceptional tonal consistency, dynamic response, and playing feel across multiple performance environments.
- Maintains dynamic playing feel
- Enhances professional versatility
- Expands real-world usability

Back Panel: Venue Mode™ Attenuator

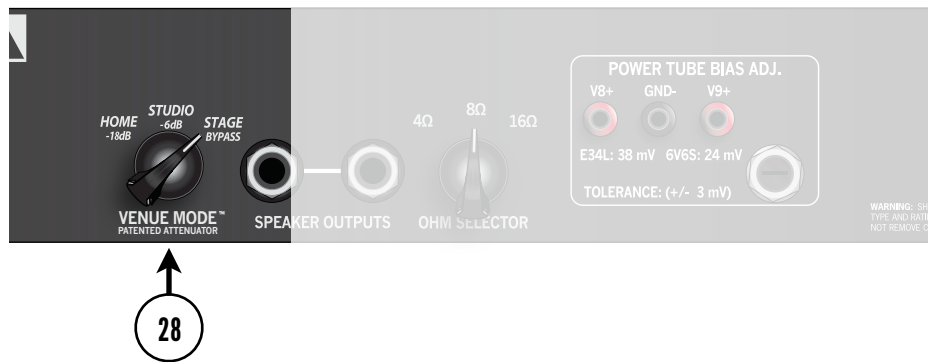

VENUE MODE™ Operating Modes (28):

Home Mode™ (-12dB / Approx. 12W Output)

Designed for home use and lower-volume performance situations while preserving the amplifier's essential voice, feel, and responsiveness.

Studio Mode™ (-6dB / Approx. 25W Output)

Provides an ideal balance of power, feel, and tonal integrity for studio use, rehearsals, medium-sized venues, and a wide variety of live applications.

Stage Mode™ (Bypass / 40W Output)

Delivers the amplifier's complete stock performance, maximum headroom, and full dynamic authority.

IMPORTANT:

Venue Mode™ is engineered to work in conjunction with Hybrid-MASTER™ technology, providing exceptional control over volume, response, and overall performance adaptability.

For optimal results, experiment with Venue Mode™ and Hybrid-MASTER™ settings together to tailor your amplifier's response for your specific musical environment.

Back Panel: Tube Effects Loop

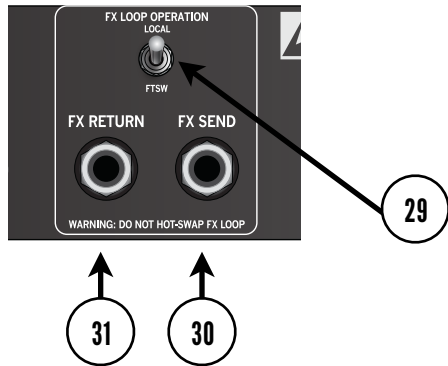

Tube Effects Loop

Experience studio-quality tone from your pedals or multi-effects units by utilizing the Kitchen Sink 6VEL's tube-driven effects loop. Designed for exceptional clarity, dynamics, and signal integrity, this loop allows your external effects to perform at their highest potential. For added flexibility, the effects loop can also be assigned to Footswitch Bus control for convenient remote operation.

FX Loop Operation Switch (29)

Choose LOCAL to retain the loop in the signal chain at all times. Choose FTSW to place the loop under command of your foot switch controller (either the included foot switch or a 3rd party switching system).

FX Send Jack (30)

This 1/4" mono Tip/Sleeve jack feeds signal to your effects device.

FX Return Jack (31)

This 1/4" mono Tip/Sleeve jack accepts the return signal from your effects device.

OPERATION NOTES:

- The FX SEND jack delivers a nominal -10dBV signal level, optimized for compatibility with most vintage and modern pedals.
- The FX RETURN path offers exceptional headroom, accommodating both pedal-level and professional-grade effects units with clarity and dynamic integrity.
- In the event of pedalboard failure, plugging directly into the FX RETURN jack can provide an emergency backup signal path through the amplifier's clean power section.

CAUTION:

- Avoid "hot swapping" any cables connected to the effects loop while the amplifier is fully operational.
- Before connecting or disconnecting loop devices, always place the amplifier in Standby Mode.
- Failure to do so may result in loud pops, hum, or signal spikes that could potentially damage speakers or connected equipment.

Back Panel: Foot Switch System

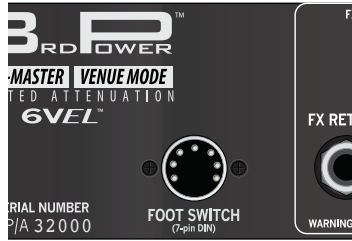

Foot Switch Connector (32)

The included remote footswitch gives you full control of the KITCHEN SINK's advanced 6VEL features. A high-quality 20' 7-pin DIN cable connects the pedal to the amplifier, which provides phantom power for LED operation.

Channel Switching:

Set the front-panel mini toggle next to the input jack to FTSW. This enables remote footswitch control of channel switching.

+GAIN (ch. 2 only):

Set the +GAIN mini toggle (between Gain and Volume on Channel 2) to FTSW. This allows remote footswitch control of the extra gain function.

Hybrid-MASTER™ Bypass (Boost):

Hybrid-MASTER™ Bypass is always connected to the FS Bus. To disable boost, turn Bypass fully counter-clockwise to zero. For setup, begin with Bypass at zero. Set your rhythm volume with the Hybrid-MASTER™ control (start around 11 o'clock). Engage HM Bypass on the footswitch, then slowly raise the Bypass control until your ideal lead boost is reached. You can now switch between rhythm and boosted lead volumes instantly.

FX Loop On/Off:

Set the rear mini toggle to FTSW to assign FX Loop on/off to the FS Bus.

4 Button Pro Foot Switch Controller:



Channel Select (33):

Toggles between channel one and channel two (amp must be placed in FS mode - see 9).

+Gain On/Off (34):

Adds preamp gain on channel two for more sustain (amp must be placed in FS mode - see 18).

+Gain *FTSW Bus Assign* (35):

Assigns +Gain switching to the FTSW Bus button (see 37).

FX Loop On/Off (36)

Toggles FX Loop on and off (amp must be placed in FS mode - see 28).

FX Loop *FTSW Bus Assign* (37):

Assigns FX Loop switching to the FTSW Bus button (see 37).

Solo Boost (38):

Toggles Hybrid-MASTER™ Bypass for instant lead boost activation. Using the onboard mini toggles, multiple features may also be assigned to the FS Bus button for expanded switching control.

WARNING:

- The Kitchen Sink 6VEL footswitching system must remain electrically isolated and cannot share an electrical ground with other devices.
- When mounting the included 4-button footswitch on a pedalboard, switcher system, or metal tray, care must be taken to prevent direct metal-to-metal contact with other grounded devices or surfaces. Failure to maintain proper isolation may result in switching malfunctions or unintended operational issues.

Proper Power & Rectifier Tube Use:

Your amplifier is shipped with factory bias settings optimized for maximum flexibility, performance, and operational safety. During final quality control and testing, the amplifier is biased to a maximum safe power dissipation level—approximately 60% of the installed tube's performance rating. The factory bias setting for your specific unit is documented on the rear panel.

Factory Tube Complement:

Unless otherwise specified by the customer or dealer, the Kitchen Sink 6VEL is equipped with:

- JJ E34L power tubes
- JJ 5U4 rectifier tube

Tube Replacement Guidelines:

- Output tubes must always be replaced in properly matched, like-kind pairs
- Never operate mixed output tube types, as improper tube combinations may result in unsafe operation or amplifier damage
- Rectifier tubes may be safely substituted with approved compatible types

Important:

Always use extreme caution when replacing tubes and ensure that all tubes are installed in their correct socket positions. Improper tube installation may create hazardous conditions or damage the amplifier.

OPERATION NOTES:

Please refer to the chassis/tube layout on page 19 when attempting to swap any tube.

Proper Power & Rectifier Tube Use: Continued

ABOUT POWER SUPPLY RECTIFIERS:

Your amplifier's power supply begins with the rectifier, which converts incoming AC wall power into the DC voltage required by the amplifier's circuitry.

Modern diode rectifiers use semiconductor technology to provide highly efficient, fast, and reliable power conversion with minimal loss.

Tube rectifiers, while less efficient and more maintenance-intensive, introduce a unique dynamic response that many players value for its feel, compression, and musical character.

So why offer both?

Because rectifier choice is not simply about power—it is about response.

- **Diode Rectification:** Fast, tight, punchy, immediate
- **Tube Rectification:** Softer attack, natural sag, compression, vintage feel

The Kitchen Sink 6VEL allows you to choose the power supply response that best complements your playing style and musical goals.

EXPLORING ‘BROWN SOUND’ CHARACTERISTICS:

Legendary “brown sound” tones are often associated with vintage Plexi-style amplifiers operating under reduced voltage conditions, combined with carefully optimized bias settings.

Historically, this approach produced:

- Lower overall DC operating voltage
- Reduced perceived loudness
- Increased gain-stage saturation
- Enhanced harmonic complexity
- Softer attack and compression

At 3RD POWER, we explored these characteristics extensively and found that similar tonal results can be achieved within the Kitchen Sink 6VEL through strategic tube and rectifier selection.

For enhanced “brown” tonal character, we recommend:

- JJ E34L power tubes
- JJ 5U4GB rectifier tube
- Tube Rectifier Mode selected

This configuration lowers operating voltage, softens response, and shifts the amplifier into a more harmonically rich, saturated performance range—delivering expressive vintage-inspired feel while maintaining reliability and flexibility.

Tube Layout/Socket Location:

Tube Layout and Requirements:

- V1: JJ 12AX7 (Preamp)
- V2: JJ 12AX7 (Tone Stack)
- V3: JJ 12AX7 (FX Loop)
- V4: Sovtek 12AX7LPS (Phase Inverter)
- V5 and V6: Matched JJ E34L output tubes

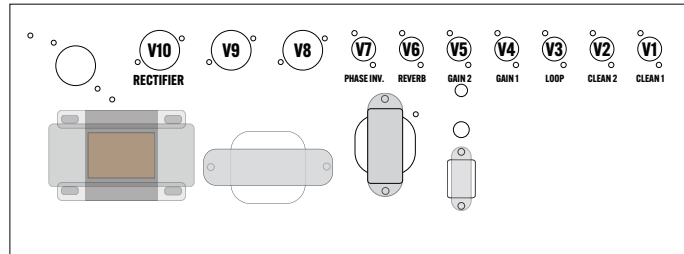

Swapping Tubes and Bias Adjustment

Your KITCHEN SINK 6VEL is factory-biased for safe and optimal operation with the installed tube set. Limited bias adjustment is available via the rear-panel bias terminals, allowing flexibility for compatible tube substitutions while maintaining important safety margins.

Always follow the recommended procedures and bias specifications carefully. Observe all warnings and cautions, as both your personal safety and the safe operation of your amplifier depend on proper handling.

The user bias circuit has been intentionally designed with a limited adjustment range to provide practical flexibility while preventing unsafe operating conditions.

Under no circumstances should you open the amplifier chassis or attempt internal circuit modifications to expand the bias adjustment range. Doing so may expose you to dangerous high-voltage electricity capable of causing serious injury or death.

DO NOT ATTEMPT INTERNAL MODIFICATIONS YOURSELF.

Tube Replacement

The safest method for changing tubes is to have your amplifier serviced by a qualified technician.

If you choose to replace tubes yourself:

- Power the amplifier off completely
- Disconnect the power cord from the AC outlet
- Allow sufficient time for all tubes to fully cool before handling

WARNING:

- Never touch tubes while the amplifier is powered on or shortly after operation
- Tube temperatures can cause severe burns
- Tubes are made of glass and may break if mishandled

ELECTRICAL WARNING:

Do not touch tube pins during removal or installation. Even after the amplifier has been powered off and unplugged, internal capacitors may retain potentially lethal high-voltage charge. Failure to observe proper precautions may result in severe injury or death.

Back Panel: Power Tube Biasing

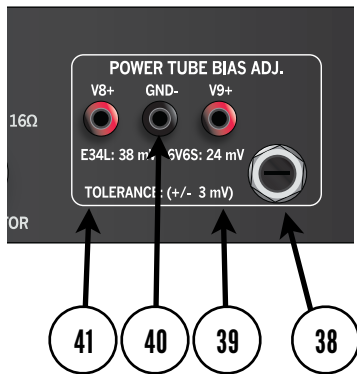

CAUTION:

Never touch hot tubes. Operating temperatures can exceed 500°F (260°C) and may cause severe burns or injury. Allow sufficient cooling time before handling or servicing the amplifier.

CAUTION:

Read all information and procedures in this section thoroughly before attempting to modify the factory bias settings of your amplifier.

Power Tube Bias Adjustment Control (38)

Controls the amount of negative DC bias voltage applied to both output tube input grids. Using a small flathead screwdriver, insert into the control port and adjust as follows:

- Counterclockwise: Lowers the idle current setting (cooler operation)
- Clockwise: Increases the idle current setting (hotter operation)

Always make bias adjustments carefully and according to proper operating procedures.

V9+ Voltage Reading Terminal (39)

This terminal is internally connected to a 1-ohm resistor on the output tube cathode of V9 (the power tube on the right side). When monitoring current at this point, your portable multimeter will display the reading in millivolts (mV). Connect your positive (+) test lead (typically red) to this terminal for accurate measurement.

GND- Terminal (40)

This terminal is internally connected to chassis ground. When monitoring the current of either output tube, connect your negative (-) test lead (typically black) to this terminal.

V8+ Voltage Reading Terminal (41)

This terminal is internally connected to a 1-ohm resistor on the output tube cathode of V8 (the power tube on the left side). When monitoring current at this point, your portable multimeter will display the reading in millivolts (mV). Connect your positive (+) test lead (typically red) to this terminal for accurate measurement.

Power Tube Biasing:

CAUTION:

Biasing your tube amplifier does not need to be intimidating, as the process is generally straightforward when proper procedures are followed. Carefully observe all warnings, cautions, and instructions before proceeding.

If you are uncertain about any part of the process, do not attempt to adjust the factory bias settings. Improper bias adjustment may result in equipment damage or personal injury.

If, during the biasing process, you hear a loud pop, observe a tube flash, or notice any abnormal behavior, immediately power down the amplifier and consult a qualified tube amplifier service technician.

BIAS ADJUSTMENT PROCEDURE:

To properly monitor and adjust your output tube bias, the amplifier must be powered on and operating at idle current. This means:

- No audio signal should be present at the INPUT jack
- No signal should be present at the FX RETURN
- A properly matched speaker cabinet must be connected at all times

Measuring Bias:

- Connect the negative (black) test lead from your multimeter to the GND- terminal on the rear panel.
- Connect the positive (red) test lead to either the V8+ or V9+ terminal, one tube at a time.
- Record each reading in millivolts (mV).
- The readings between V8 and V9 should be within approximately 6mV of each other.
- Always base your maximum bias setting on the higher reading of the two tubes.

Adjusting Bias:

- Using a small flathead screwdriver, insert into the bias control port:
- Clockwise: Increases idle current (hotter bias)
- Counterclockwise: Decreases idle current (cooler bias)

Performance Considerations:

- Cooler Bias Settings: May increase tube life, but overly cool settings can result in brash, thin, or less dynamic tone
- Hotter Bias Settings: Can improve warmth, feel, and harmonic richness, but may reduce tube life-span if set excessively high

Recommended Operating Range:

- Optimal tone and feel are generally achieved when bias is set within approximately 50%–70% of your output tube's maximum operating range.
- This range may vary depending on the specific type and brand of power tubes installed. Always bias conservatively and within safe operating limits.

Accessories:



Breakout Box

The optional Breakout Box allows you to seamlessly integrate your amplifier's switching functions with an external switching system.

The Breakout Box converts the amplifier's 7-pin DIN footswitch output into individual 1/4" TS jacks, assigning each footswitchable parameter to its own dedicated connection point.

This provides convenient compatibility with advanced switching systems, pedalboard controllers, and professional rig management setups.

WARNING:

Any remote footswitching system used with the Breakout Box must feature isolated ground connections.

The Kitchen Sink 6VEL footswitching system cannot share an electrical ground with any external device. Improper grounding may result in switching malfunctions or potential system damage.

When mounting the Breakout Box on a pedalboard, switcher platform, or metal tray, extreme care should be taken to prevent direct metal-to-metal contact with other grounded devices or surfaces.

Proper electrical isolation must be maintained at all times.

LIMITED LIFETIME WARRANTY

Thank you for choosing 3RD POWER Amplification. We take great pride in designing and building high-quality tube amplifiers and speaker cabinets, and every product is thoroughly tested prior to shipment.

Amplifier Coverage

Your amplifier is warranted to the original purchaser to be free from defects in materials and workmanship for as long as you own it. Proof of original purchase, including a dated sales receipt, is required to establish warranty coverage.

This warranty does not cover service, repair, or replacement resulting from:

- Accident
- Neglect
- Abuse
- Misuse
- Over-powering
- Normal wear
- Natural disasters
- Unauthorized modifications or repairs
- Improper packing or shipping procedures

If a defect in materials or workmanship is confirmed, your sole remedy under this warranty is repair or replacement at the discretion of 3RD POWER.

Tube Warranty

3RD POWER warrants the original purchaser that factory-installed tubes will be free from defects in materials and workmanship for a period of 30 days from the original purchase date.

A dated sales receipt is required for warranty validation.

If tubes fail within this 30-day period, your sole remedy is replacement of the defective tubes.

Return Procedures

In the unlikely event that warranty service is required:

1. Obtain a Return Authorization (RA) Number from 3RD POWER prior to shipping
2. Ship the product freight prepaid and insured
3. Include proof of purchase
4. Use original packaging or equivalent protective packaging
5. Clearly mark the RA number in large print below the shipping address
6. Include:
 - Brief description of the defect
 - Correct return address
 - Telephone number

Important:

The purchaser assumes all risk of loss or damage during transit to 3RD POWER.

LIMITED LIFETIME WARRANTY: Continued

Warranty Service

If 3RD POWER determines that the product is defective under warranty terms, we may:

- Repair the product
- Replace the product

at no additional charge, except for non-covered costs.

All replaced parts become property of 3RD POWER.

Products repaired or replaced under warranty will be returned via standard ground shipping within the United States at no charge.

3RD POWER is not responsible for expedited shipping charges to or from our facility.

Limitation of Liability

3RD POWER shall not be liable for incidental or consequential damages arising from the use or inability to use any 3RD POWER product, even if advised of the possibility of such damages.

Some states do not allow limitations on incidental or consequential damages, so certain exclusions may not apply.

This warranty provides specific legal rights, and you may also have additional rights that vary by state.

Product Registration

For your protection, please complete and return the Purchase Information Card within ten (10) days of purchase. This allows us to contact you directly in the event of a product safety notification in accordance with the Consumer Product Safety Act of 1972.

Customer Support

Our dedicated support team is available to assist with product-related questions.

3RD POWER Customer Support
(615) 945-3393
Monday–Friday
9:00 AM – 5:00 PM Central Time



3RD POWER Amplification
7605 Washington Ave S
Edina, MN 55439
Phone: (615) 945-3393

Web Site
www.3rdPower.com